

## DOME HOLDING SYSTEM

■ **MediCon Dome Holding System** is intended to be integrated into extracorporeal circulation devices where the pressure within the tubing set is measured in a non-invasive way, through the coupling between a surface pressure sensor and a disposable membrane element called "dome". The Dome Holding System is used to keep the dome in a fixed position on the sensor, avoiding rotation or lateral displacement caused by any operator action on the tubing set. The dome locking/unlocking system consists of a sliding mechanism, and the opening/closing position is continuously monitored by a slotted optical switch.

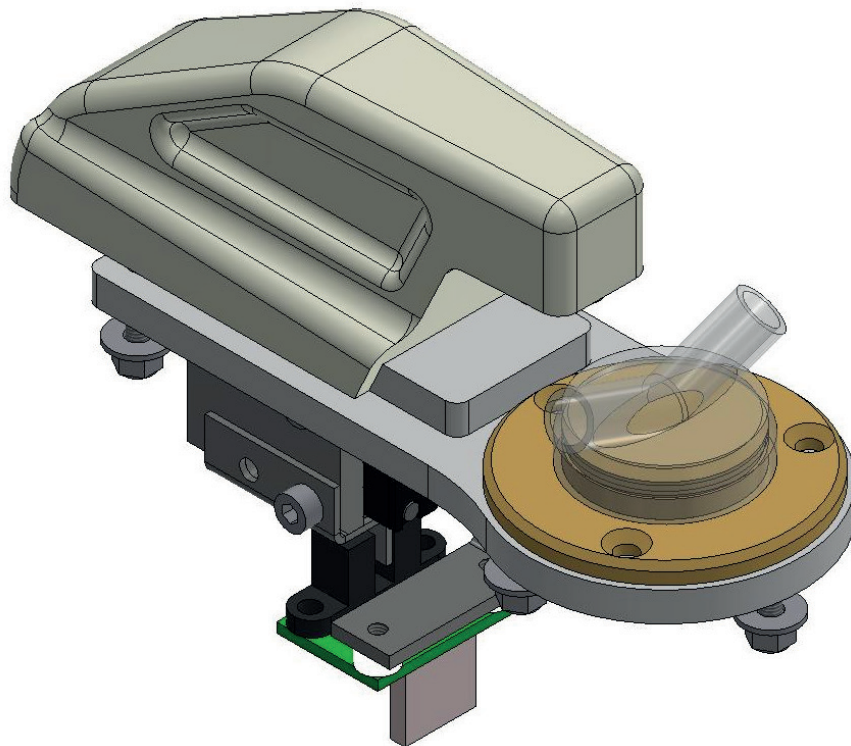

## Key features - 1

### Dome Holding System **CLOSED** Position

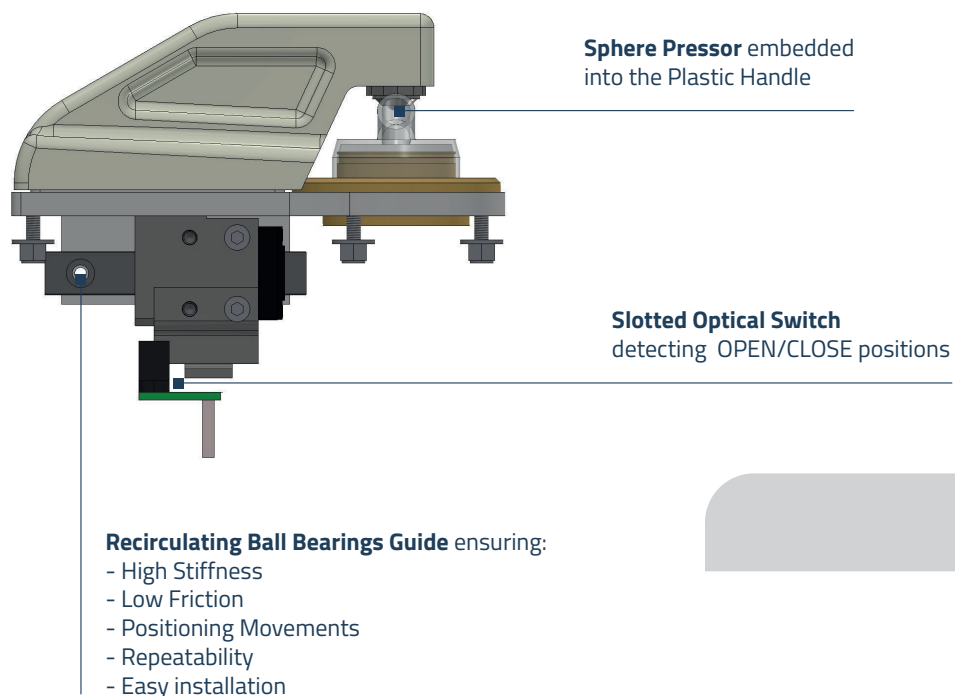

## Key features - 2

### Dome Holding System **OPEN** Position

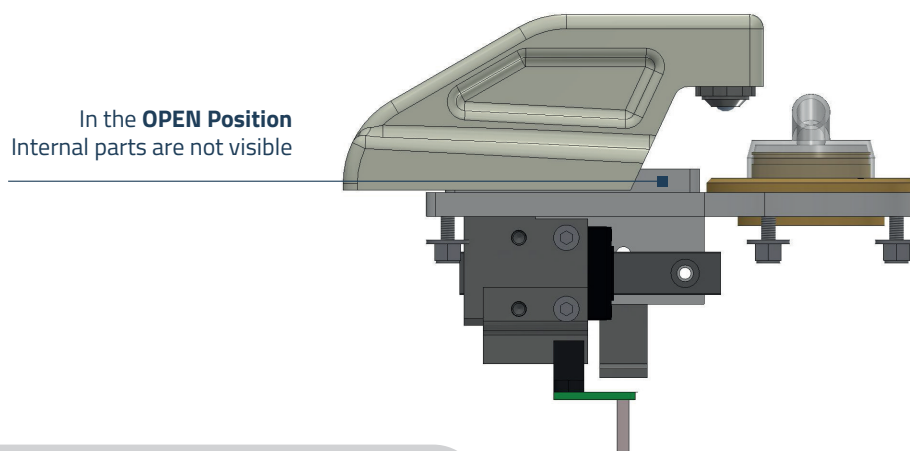

## Mounting system and electrical interface

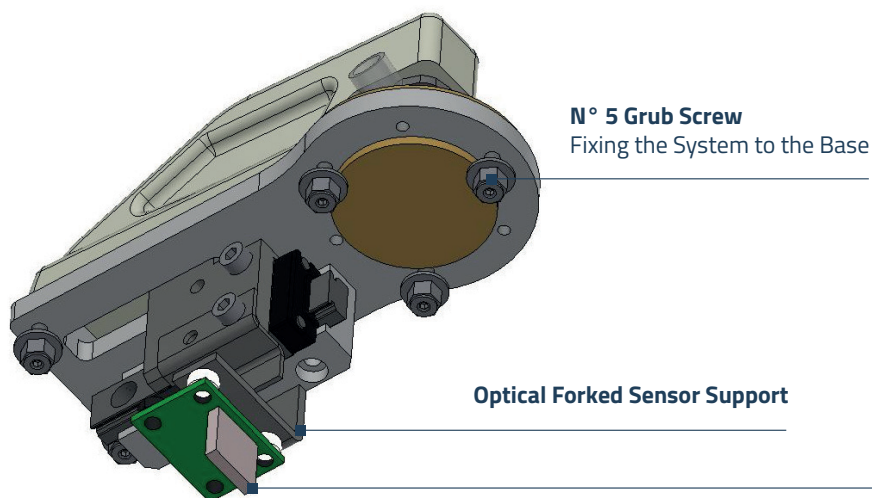

Connector: **Manufacturer JST - type B4B-XH-A**

Direct Interface to Slotted Optical Switch:

- Manufacturer: OPTEK TECHNOLOGY
- Type: OPB360T51

Pinout:

- Pin1: phototransistor collector
- Pin2: emitter anode
- Pin3: emitter cathode
- Pin4: phototransistor emitter

The sensor interface may be customized